



Castles

FURTHERGROUND  
Adeyfield, Hemel Hempstead HP2 4LQ



# FURTHERGROUND

## Adeyfield, Hemel Hempstead HP2 4LQ

**O.I.E.O £450,000**

(Freehold)



This highly attractive property is light and spacious, well maintained and offering all the benefits of a good-sized family home.

The Entrance Porch draws visitors towards the large Reception areas which comprise a comfortable Living area complete with fitted shelving and storage space and a very large Kitchen / Diner which has the benefit of underfloor heating.

The Kitchen is modern and designed to include all the appliances and storage needed for today's lifestyle. It has high-spec integrated appliances alongside impressive décor and finishes.

There is direct access to the garden from the Dining area, straight onto the lawn surrounded by all-round fencing to provide perfect seclusion.

Upstairs offers three good sized Bedrooms, all decorated to high standards. Each is served by a fully tiled and a traditional but thoroughly modern family Bathroom.

This house has a very homely feel, with a sense of contentment and comfort derived from being well maintained and positioned in the heart of a thriving community.

Tenure: Freehold  
Council Tax Band: C  
EPC Rating: D

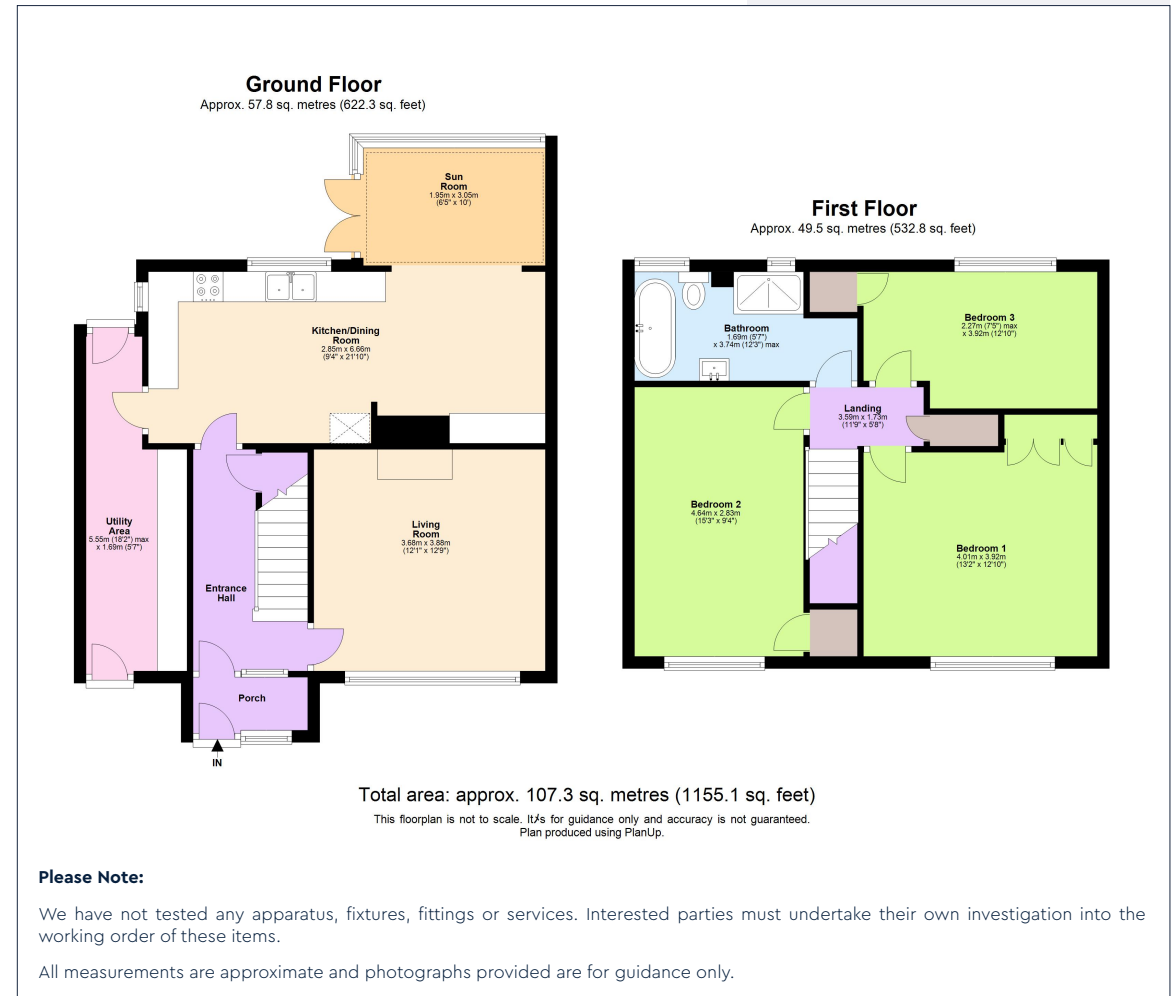

**Berkhamsted Office:** 148 High Street, Berkhamsted, Hertfordshire HP4 3AT **Tel: 01442 865252**  
**Boxmoor Office:** 33 St John's Road, Hemel Hempstead, Hertfordshire HP1 1QQ **Tel: 01442 233345**  
**Eaton Bray Office:** 2a Wallace Drive, Eaton Bray, Dunstable LU6 2DF **Tel: 01525 220605**  
**Kings Langley Office:** 1 High Street, Kings Langley, Hertfordshire WD4 8AB **Tel: 01923 936900**  
**Associated London Office:** 121 Park Lane, Mayfair, London W1K 7QG **Tel: 020 7079 1595**

[www.castlestateagents.co.uk](http://www.castlestateagents.co.uk)



# Castles