



Castles

HEATHER MEAD  
Edlesborough, Buckinghamshire



# HEATHER MEAD

## Edlesborough, Buckinghamshire

**Guide Price**  
**£425,000**  
(Freehold)

# Castles



## Main Descriptive Title



Castles Estate Agents are pleased to offer for a sale this spacious two DOUBLE bedroom SEMI-DETACHED bungalow, tucked away at the end of a quiet no-through road, just a short stroll from Edlesborough village centre. The property has ample parking to the front, and with it's position it offers the perfect blend of comfort, convenience, and countryside charm.

This well-presented two-bedroom semi-detached bungalow features a modern open plan lounge and kitchen, ideal for relaxed living and entertaining. Both bedrooms are comfortable doubles, offering ample space for family, guests, or home working.

The contemporary shower room adds to the practical layout, while the beautifully landscaped rear garden is a real highlight, backing directly onto the River Ouzel and open fields, providing a truly tranquil, scenic outlook.

The property is advertised for sale with NO UPPER CHAIN.

## Specifications

- CUL-DE-SAC LOCATION
- BUCKINGHAMSHIRE VILLAGE
- NO UPPER CHAIN
- TWO DOUBLE BEDROOMS
- GAS CENTRAL HEATING
- EASY REACH OF AMENITIES
- WALKING DISTANCE TO VILLAGE GREEN
- EDLESBOROUGH
- OFF-ROAD PARKING





Whether you're looking to downsize, invest, or simply enjoy single-level living in a peaceful yet well-connected location, this delightful bungalow is not to be missed.





**Please Note:**

We have not tested any apparatus, fixtures, fittings or services. Interested parties must undertake their own investigation into the working order of these items.

All measurements are approximate and photographs provided are for guidance only.

**Tenure: Freehold**

**Council Tax Band: D**

**EPC Rating: C**

**Ground Floor**

Approx. 81.8 sq. metres (880.0 sq. feet)

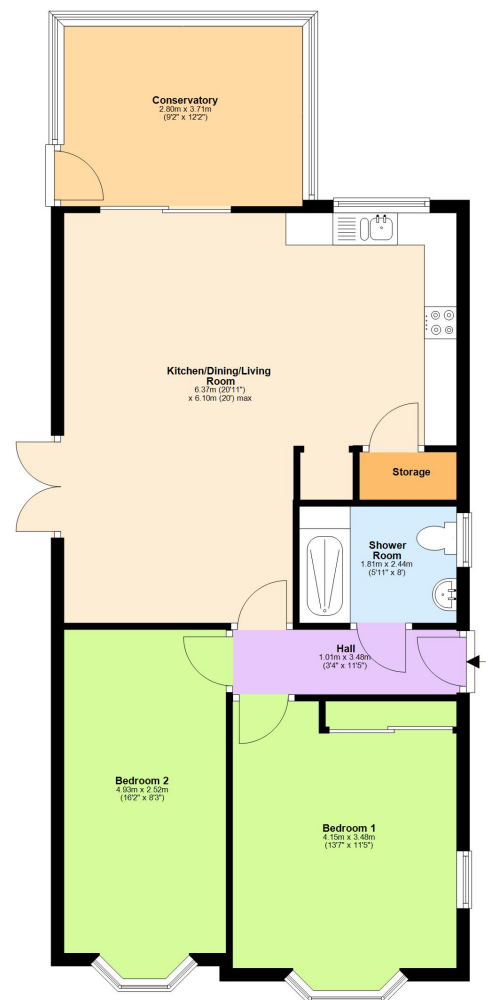

Total area: approx. 81.8 sq. metres (880.0 sq. feet)

**Berkhamsted**

01442 865252

**Eaton Bray**

01525 220605

**Borehamwood**

020 8953 2112

**Hertford**

01992 501511

**Boxmoor**

01442 233345

**Kings Langley**

01923 936900

**Bushey**

020 8950 2551

**Radlett**

01923 537111



**Castles**

[www.castlestateagents.co.uk](http://www.castlestateagents.co.uk)