

Castles

WIVELSFIELD
Eaton Bray, Bedfordshire

WIVELSFIELD

Eaton Bray, Bedfordshire

Guide Price £165,000
(Freehold)



Castles Estate Agents are pleased to represent this stylish and FULLY REFURBISHED one-bedroom TOP FLOOR apartment in a block of only three properties, situated at the end of a CUL-DE-SAC, located in the village of EATON BRAY and offered for sale with NO UPPER CHAIN. From its elevated position, this beautifully refurbished apartment offers modern living with fantastic far reaching views to include "Ivinghoe Beacon".

Part of an exclusive block of just three apartments, this home has been NEWLY DECORATED throughout, featuring brand-new carpets, stylish wood panelling, new internal doors which includes a fully glazed door, ironmongery, new windows, inset spot lights, built-in wardrobes and intercom handset. The stylish BRAND NEW kitchen comes complete with an INTEGRATED fridge & washing machine, has an inset hob and fitted oven with extractor hood, while the REFURBISHED bathroom adds to the high-quality finish. The property further benefits from a GARAGE, GAS central heating and no service charges. Offering both modern living and convenience, this fantastic home is perfect for first-time buyers, downsizers and for those looking to invest.

Tenure: Freehold
Council Tax Band: B
EPC Rating: D

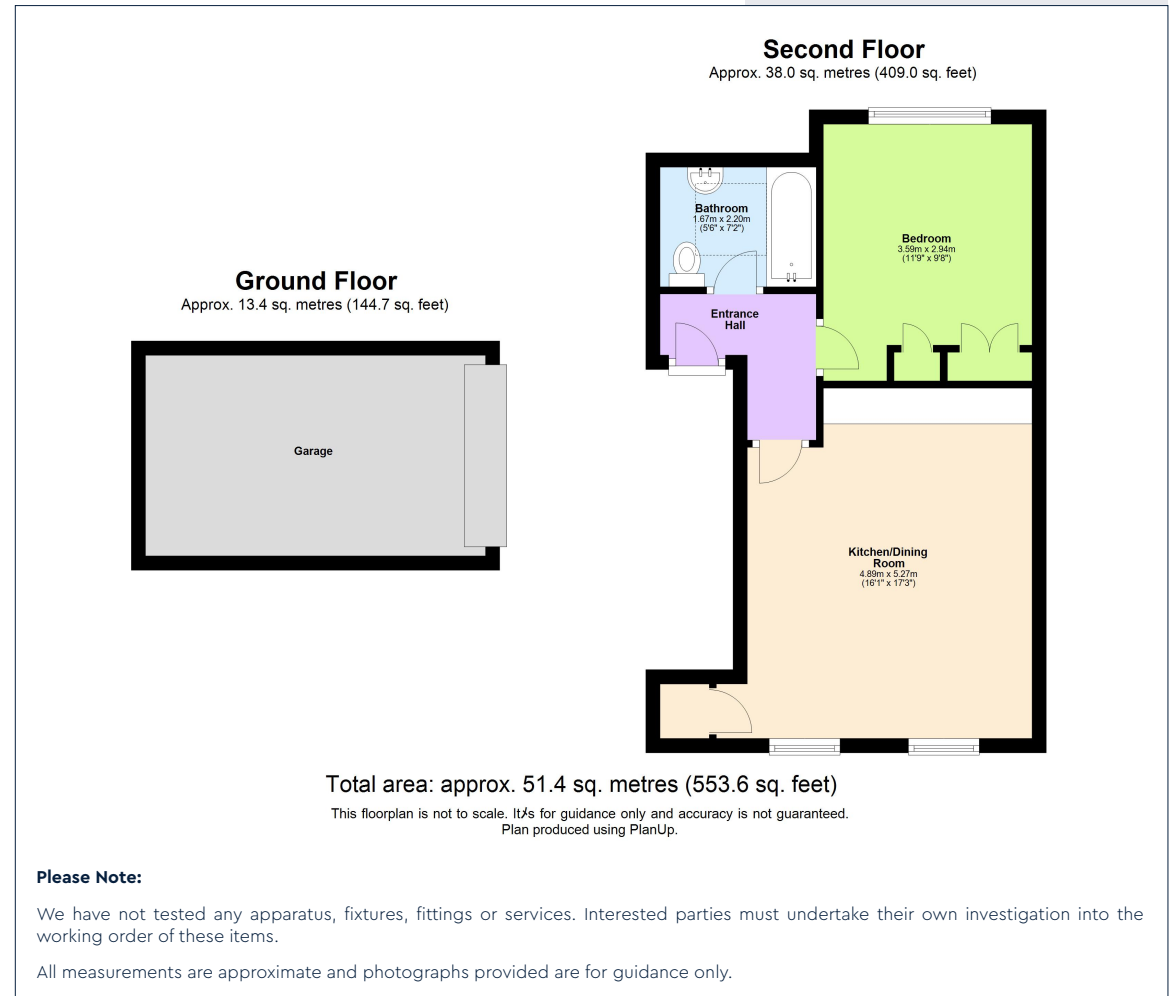

Berkhamsted
01442 865252

Borehamwood
020 8953 2112

Boxmoor
01442 233345

Bushey
020 8950 2551



Eaton Bray
01525 220605

Hertford
01992 501511

Kings Langley
01923 936900

Radlett
01923 537111

Castles

www.castlesestateagents.co.uk