



Castles

NORTHALL ROAD
Eaton Bray, Bedfordshire

NORTHALL ROAD

Eaton Bray, Bedfordshire

Asking Price £250,000
(Freehold)



Step into your perfect first home with this characterful two-bedroom SEMI-DETACHED cottage on Northall Road, nestled on the edge of a sought-after village and just moments from rolling open countryside. Castles Estate Agents are pleased to offer for sale this property with NO UPPER CHAIN

With a cosy lounge featuring a stunning fireplace, a bright kitchen providing a range of base to eye level units & drawers, ample worksurface space, recently fitted GAS BOILER and FRENCH DOORS, which open onto a private rear garden. The first floor has two bedrooms plus the bathroom.

This charming cottage blends comfort with rural charm, enjoying peaceful village life with local amenities nearby, scenic walks on your doorstep, and easy access to surrounding towns, ideal for first-time buyers and property investors.

Tenure: Freehold
Council Tax Band: B
EPC Rating: D

Ground Floor
Approx. 21.4 sq. metres (230.5 sq. feet)

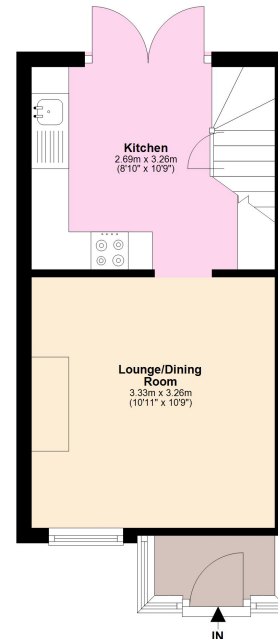

First Floor
Approx. 21.0 sq. metres (226.2 sq. feet)

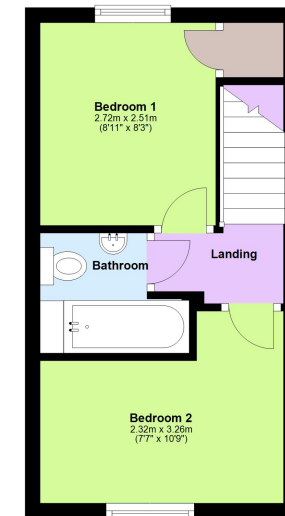

Total area: approx. 42.4 sq. metres (456.7 sq. feet)

This floorplan is not to scale. It's for guidance only and accuracy is not guaranteed.
Plan produced using PlanUp.

Please Note:

We have not tested any apparatus, fixtures, fittings or services. Interested parties must undertake their own investigation into the working order of these items.

All measurements are approximate and photographs provided are for guidance only.

Berkhamsted
01442 865252

Borehamwood
020 8953 2112

Boxmoor
01442 233345

Bushey
020 8950 2551

Eaton Bray
01525 220605

Hertford
01992 501511

Kings Langley
01923 936900

Radlett
01923 537111



Castles

www.castlesestateagents.co.uk