



Castles

BRIDGEWATER ROAD  
Berkhamsted, Hertfordshire, HP4 1JB



# BRIDGEWATER ROAD

Berkhamsted, Hertfordshire, HP4 1JB

**Guide Price**  
**£900,000**  
(Freehold)

Castles



Castles Estate Agents are pleased to present this Charming 3 Bedroom Detached Dormer Bungalow. Nestled in a highly sought - after road in Berkhamsted.



From the moment you arrive, the home's warm and welcoming presence is clear. A well-maintained front Garden and private Driveway set the tone, offering both charm and practicality.

Step inside and you're greeted by a home full of natural light and character. The layout flows effortlessly, with Three well-proportioned Bedrooms and Two versatile Reception rooms that offer flexibility for modern family living. At the rear of the property, a light-filled Conservatory provides a tranquil retreat with views across the Garden.

Outside, the mature rear Garden is a true highlight. Surrounded by established trees and shrubs, it offers a sense of privacy and calm. Whether you're dining alfresco, hosting summer barbecues, or simply enjoying the peaceful surroundings, this garden is a place to relax.

This characterful home also presents excellent potential for modernisation and extension (STPP). A detached Garage and Driveway provide ample Off-Street Parking and storage, further adding to the property's appeal. Offered with No Upper Chain, this is an exceptional opportunity to secure a forever home in a fantastic location.

## Specifications

- DETACHED
- DORMER BUNGALOW
- 3 BEDROOMS
- 2 RECEPTION ROOMS
- CONSERVATORY
- PRIVATE DRIVEWAY
- TRANQUIL LOCATION
- MATURE REAR GARDEN
- DETACHED GARAGE
- NO UPPER CHAIN
- MODERNISATION POTENTIAL





This delightful home offers a rare opportunity to secure a generously sized property on a large plot, with endless potential to truly make your own.



#### **A little about the corner of the world we call home...**

Berkhamsted is an historic market town nestled at the feet of the Chiltern Hills, a designated area of outstanding natural beauty. Berkhamsted lies in the Bourne Valley. The town is located 26 miles northwest of London. The high street is on a pre roman route to London with lots of interesting architectural styles, our own office sits in a building well over 200 years old. Berkhamsted dates back to about 1000 AD and was mentioned in the doomsday book of 1086 and has its own Castle, sadly just ruins now as it was abandoned in 1495, it now belongs to the Duchy of Cornwall and is looked after by English Heritage – the site is often used for events. Just off the High Street is the Grand Union Canal and the

Train Station which offers a frequent service in under 30 minutes to London Euston. The Town Centre has a range of independent and boutique retailers as well as national retailers such as Marks & Spencers and Waitrose. Berkhamsted is home to some of the best schools in the area, the Berkhamsted School is an independent day and boarding school dating back to 1541 with famous alumni such as Clementine Churchill, Will Fraser and more recently Roman Kemp. The town is also home to the British Film Institute and can often be seen for location filming for TV and Film. Berkhamsted really is a wonderful place to raise a family, commute into the City, check out the countryside or simply enjoy a coffee or glass of prosecco and watch the world go by.



**Please Note:**

We have not tested any apparatus, fixtures, fittings or services. Interested parties must undertake their own investigation into the working order of these items.

All measurements are approximate and photographs provided are for guidance only.

**Tenure: Freehold**

**Council Tax Band: E**

**EPC Rating: D**

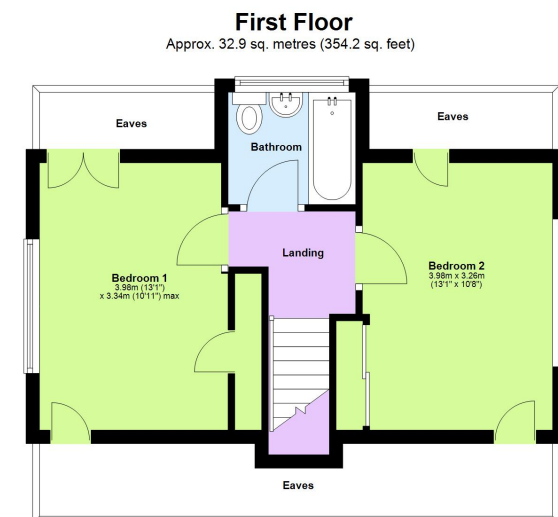
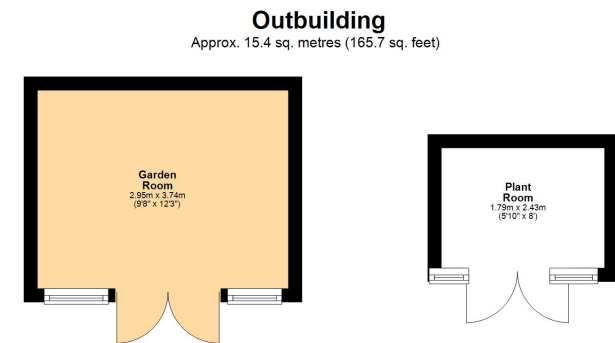

Total area: approx. 131.8 sq. metres (1418.3 sq. feet)

**Berkhamsted**

01442 865252

**Eaton Bray**

01525 220605

**Borehamwood**

020 8953 2112

**Hertford**

01992 501511

**Boxmoor**

01442 233345

**Kings Langley**

01923 936900

**Bushey**

020 8950 2551

**Radlett**

01923 537111



**Castles**

[www.castlesstateagents.co.uk](http://www.castlesstateagents.co.uk)